



Supply air/exhaust air diffuser  
lightweight design

# SDA-E



Supply air and exhaust air diffusers are intended to use as air terminal devices in low- and medium-pressure ventilation and air conditioning systems. These diffusers are recommended to use in spaces with height up to 4m. They are equipped with fixed blades pre-set at an angle of 45°.

◀ SDA-E Diffuser

# Supply air/exhaust air diffuser



## Material and finish

The frame and blades of the diffuser are integral design made of black sheet steel, normally powder coated on both sides to RAL 9010.

## Installation

Installation with use of central screw through to a plenum box.

## Typical sizes

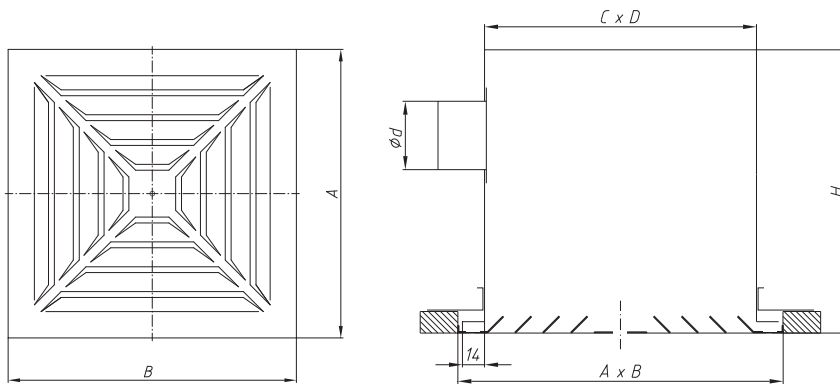

<b>C</b> [mm]	<b>A</b> [mm]	$\varnothing d$ [mm]	<b>H</b> [mm]	<b>A<sub>eff</sub></b> [m <sup>2</sup> ]	<b>weight</b> [kg]
205	245	158	270	0,021	0,52
261	301	158	270	0,036	0,78
317	357	198	330	0,054	1,08
372	412	198	330	0,089	1,43
558	598	298	430	0,219	2,97

# Supply air/exhaust air diffuser



## Technical data

Vertical and horizontal air flow range for velocity  $V_L = 0,2 \text{ m/s}$ .

SDA-E 205-45°

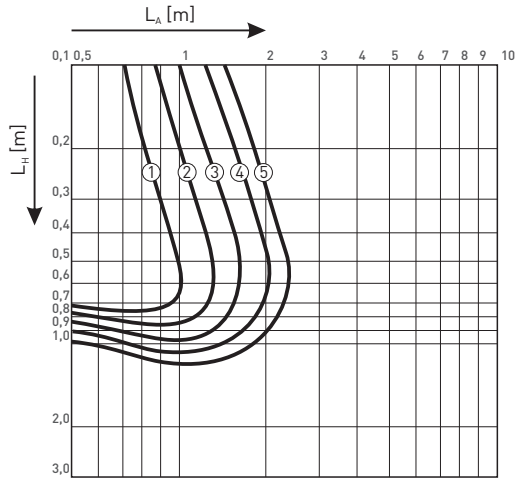

Key:

$V_t$ [ $\text{m}^3/\text{h}$ ]	volumetric air flow
$V_{\text{eff}}$ [ $\text{m}/\text{s}$ ]	effective air flow velocity
$V_L$ [ $\text{m}/\text{s}$ ]	air flow velocity at distance $L_A$
$L_A$ [ $\text{m}$ ]	air flow range in horizontal direction
$L_H$ [ $\text{m}$ ]	air flow range in vertical direction
$\Delta p$ [ $\text{Pa}$ ]	total pressure drop
$L_w$ [ $\text{dB}_{(\text{A})}$ ]	sound power level

	$V_t$ [ $\text{m}^3/\text{h}$ ]	$V_{\text{eff}}$ [ $\text{m}/\text{s}$ ]
①	75	1,0
②	151	2,0
③	227	3,0
④	302	4,0
⑤	378	5,0

SDA-E 261-45°

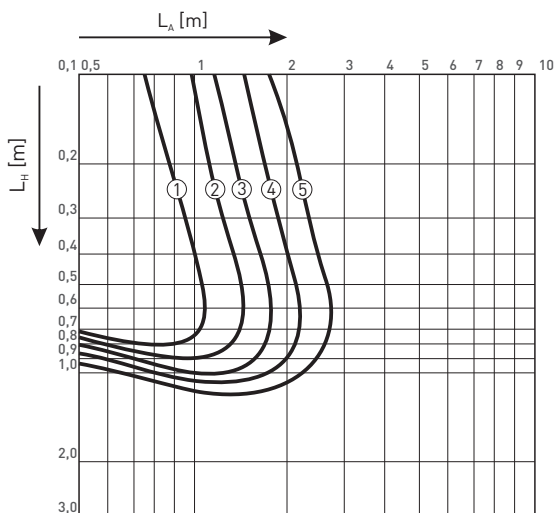

	$V_t$ [ $\text{m}^3/\text{h}$ ]	$V_{\text{eff}}$ [ $\text{m}/\text{s}$ ]
①	130	1,0
②	259	2,0
③	389	3,0
④	518	4,0
⑤	648	5,0

# Supply air/exhaust air diffuser



## Technical data

SDA-E 317-45°

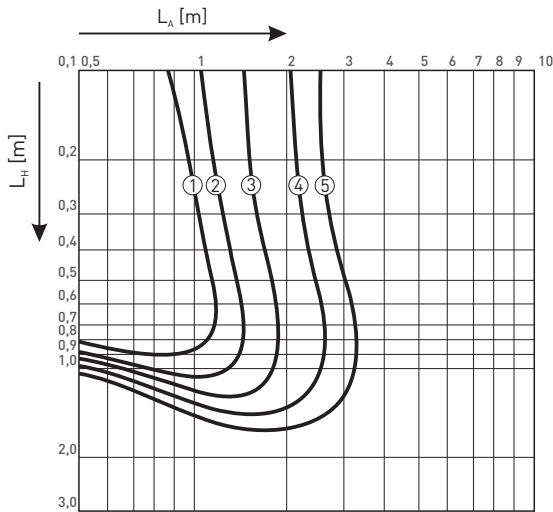

	$V_t$ [m <sup>3</sup> /h]	$V_{eff}$ [m/s]
①	194	1,0
②	389	2,0
③	583	3,0
④	778	4,0
⑤	972	5,0

SDA-E 372-45°

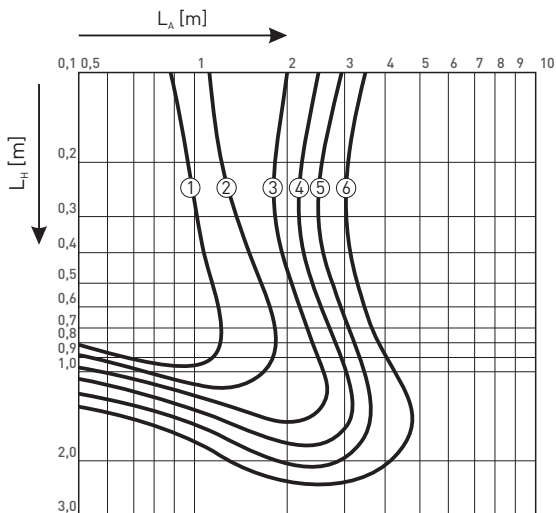

	$V_t$ [m <sup>3</sup> /h]	$V_{eff}$ [m/s]
①	324	1,0
②	648	2,0
③	972	3,0
④	1296	4,0
⑤	1620	5,0
⑥	1944	6,0

# Supply air/exhaust air diffuser



## Technical data

SDA-E 558-45°

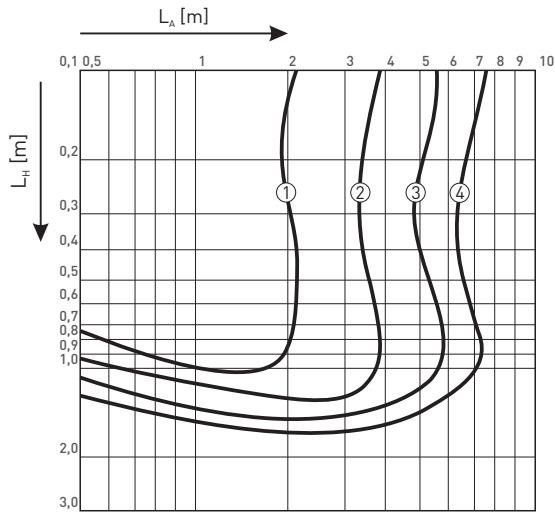

	$V_i$ [m <sup>3</sup> /h]	$V_{eff}$ [m/s]
①	788	1,0
②	1577	2,0
③	2365	3,0
④	3166	4,0

### Pressure drop and sound power level

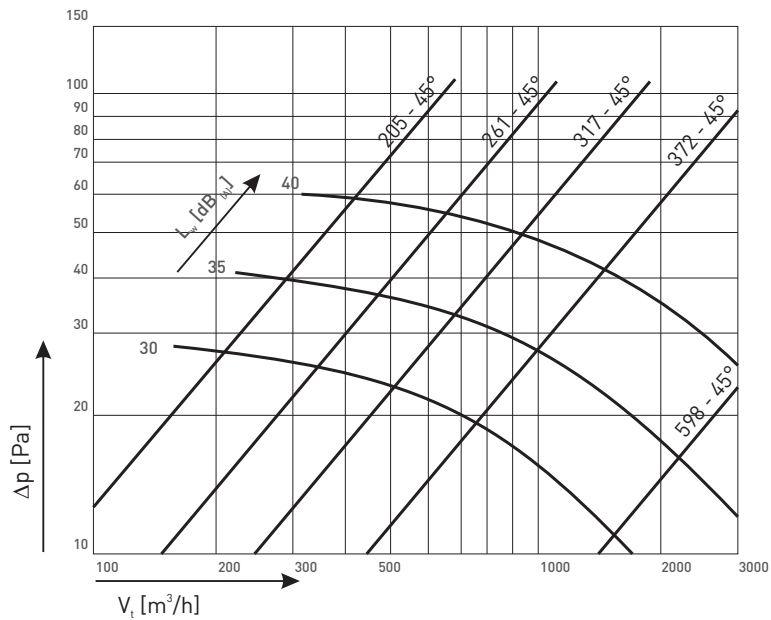

## Accessories and order code



While ordering, please provide the information using the following method:

**SDA - E -4-<C>x<D>-SL9010 / <ADD>**

Gdzie:

- <C> - width of the installation opening in [mm]
- <D> - length of the installation opening in [mm]
- SL9010** - steel, powder coated to RAL 9010
- <ADD> - Additional accessories according to the list below:

Accessories:

Plenum box according to the configuration as follows:

<SR><I>-<H>-<K>-<D><R>

<I> - Insulation:\*

**None - no insulation**

T - insulated

<H> - height of the plenum box in [mm]\*

<K> - connector position:

**b - side**

g - top

<D> - diameter of the connection fitting in [mm]\*

<R> - control: \*

**None- no damper**

P - damper with adjustment outside the plenum box

\*optional values - default values will be used if optional values are not specified

Order example:

**SDA-E-4-261x261-SL9010/SRt-270-b158**